

SURGiNG

紹 鑫 實 業



Midget Fuse

新能源熔断器

EV40 Series



EV40 Semi-conductor Fuse



快速半导体熔断器

High speed semi-conductor Fuse



测试标准:
Testing Standard:
UL248-1 UL248-13

额定分断能力:
Interrupting Rating:
20000 Amperes at 750V DC
100000 Amperes at 750V AC

工作温度:
Operating Temperature:
-55°C~+125°C

材料/Material:
Terminals: Tin plated copper
Tube: Ceramic Tube
Element: Silver alloy
Filler: Silica Sand

Time-Current Characteristics
电流-时间曲线图

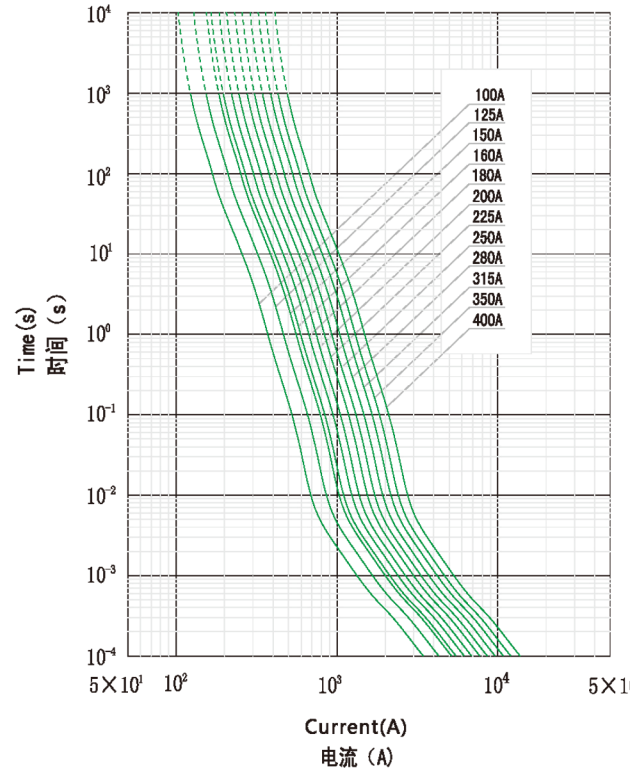

电气特性: Electrical Characteristics

% Ampere Rating	Opening Time
100%	4Hours Min.
200%	300 Seconds Max.

产品尺寸: Dimension

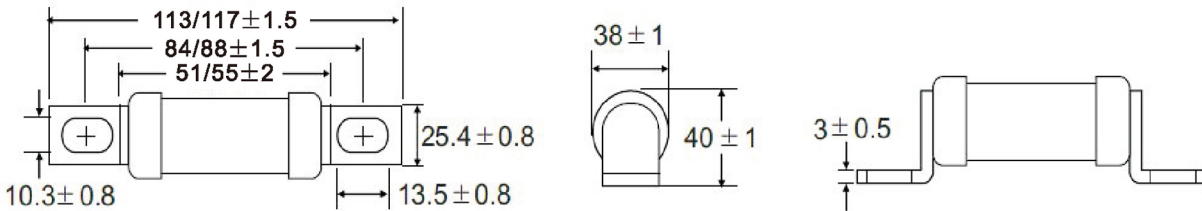

目录编号/Catalog No.: 编号中V750表示750VDC, 500VDC, 600VDC, 700VDC将分别用V500,V600,V700表示; 末尾的A/B分别表示不同的接脚。

目录编号 Catalog No.	额定电流 Ampere Rating	额定电压 Voltage Rating	Energy Integrals I ² t(A ² S)		功耗(w) Power Loss	认证 Approvals
			Pre-Acting	at 750V		
EV40V750-100A/B	100A	750VDC/AC	470	2800	22	●
EV40V750-125A/B	125A	750VDC/AC	1100	6500	31	●
EV40V750-150A/B	150A	750VDC/AC	1100	6500	38	●
EV40V750-160A/B	160A	750VDC/AC	1200	8500	39	●
EV40V750-180A/B	180A	750VDC/AC	1400	13500	40	●
EV40V750-200A/B	200A	750VDC/AC	2600	18500	41	●
EV40V750-225A/B	225A	750VDC/AC	3700	26500	45	●
EV40V750-250A/B	250A	750VDC/AC	5300	55000	47	●
EV40V750-280A/B	280A	750VDC/AC	7000	55000	51	●
EV40V750-315A/B	315A	750VDC/AC	10000	77000	58	●
EV40V750-350A/B	350A	750VDC/AC	15000	105000	59	●
EV40V750-400A/B	400A	750VDC/AC	20000	145000	61	●